

EN

SANDWICH PANELS FOR
SECTIONAL DOORS

WE OFFER SYSTEM SOLUTIONS
 AN INDIVIDUAL APPROACH
 ORDERING ON-LINE
 FLEXIBLE PRICING POLICY

An individual solution for you

STRUCTURE OF SANDWICH PANELS

FINGER PROTECTION PANEL

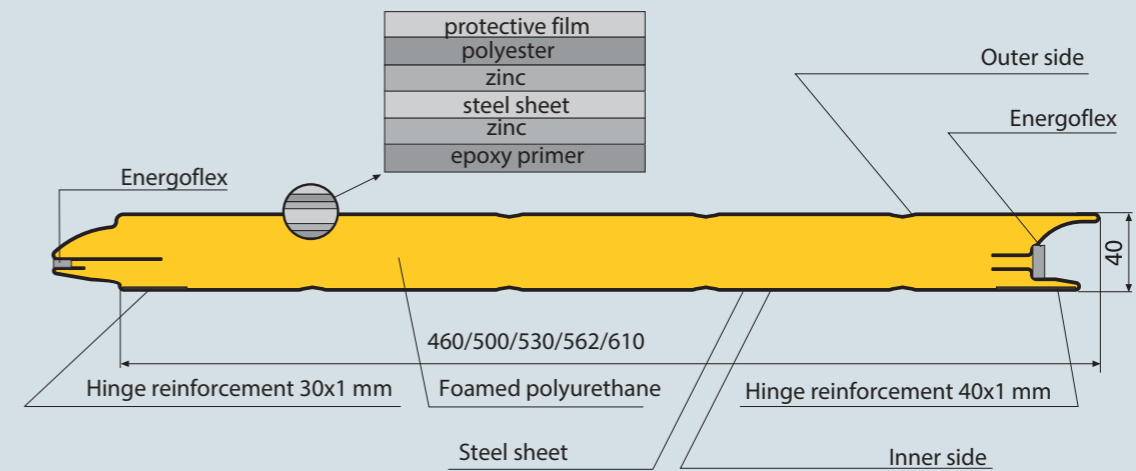

INDUSTRIAL PANEL WITHOUT FINGER PROTECTION

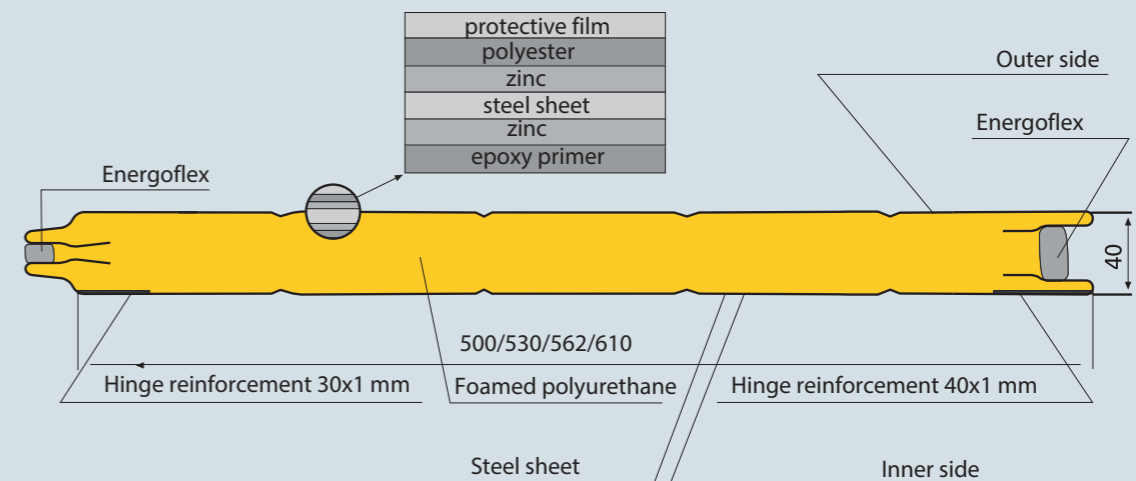

FRONTSIDE PANEL DESIGN

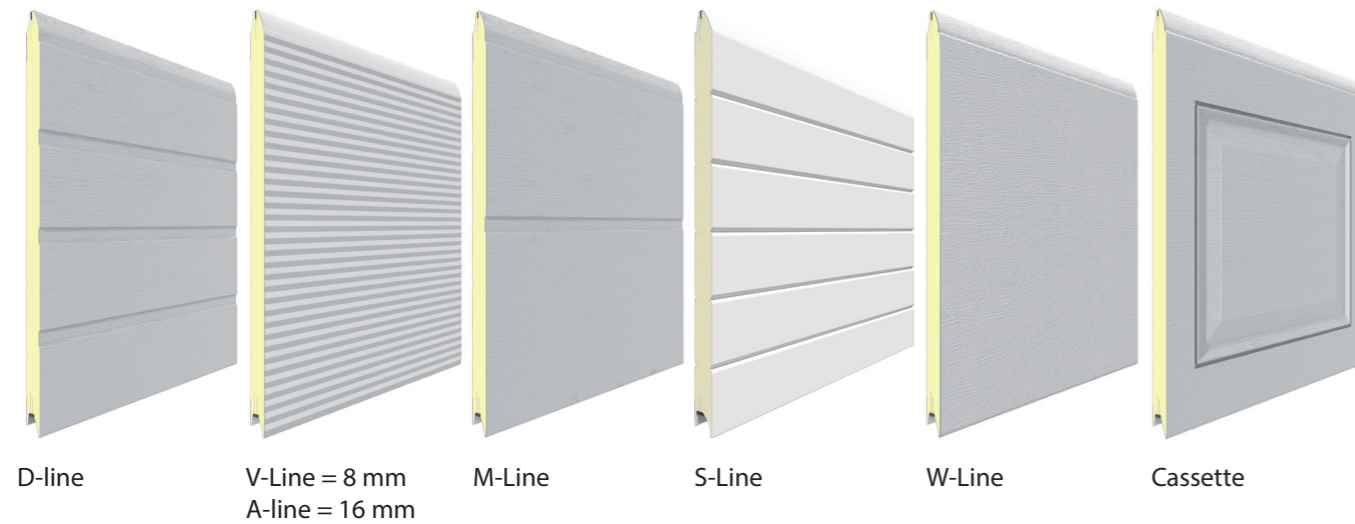

SURFACE STRUCTURES



PRINTING



STANDARD RAL COLORS

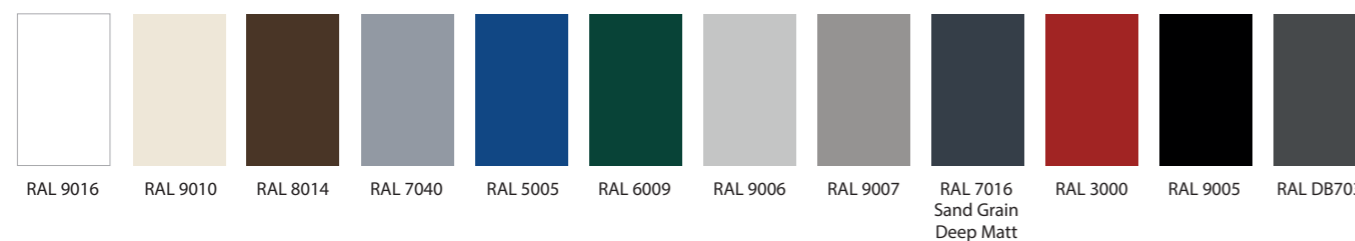

Panels can be painted in any color from the International RAL Color Chart. Color swatches printed on this page may not accurately display the original colors. Please use the original RAL Color Chart.

THERMAL PROPERTIES AND PACKING OF SANDWICH PANELS

THERMAL PROPERTIES

NO COLD BRIDGE EFFECT
- the front and back sheets are not connected, which ensures heat insulation and prevents freezing.

FOAMED POLYURETHANE
- the seal made of high-quality material increases the durability of the sandwich panels and reduces heat loss.

ENERGOFLEX
- advanced technology of heat insulation, non-absorbing and wear-resistant material.

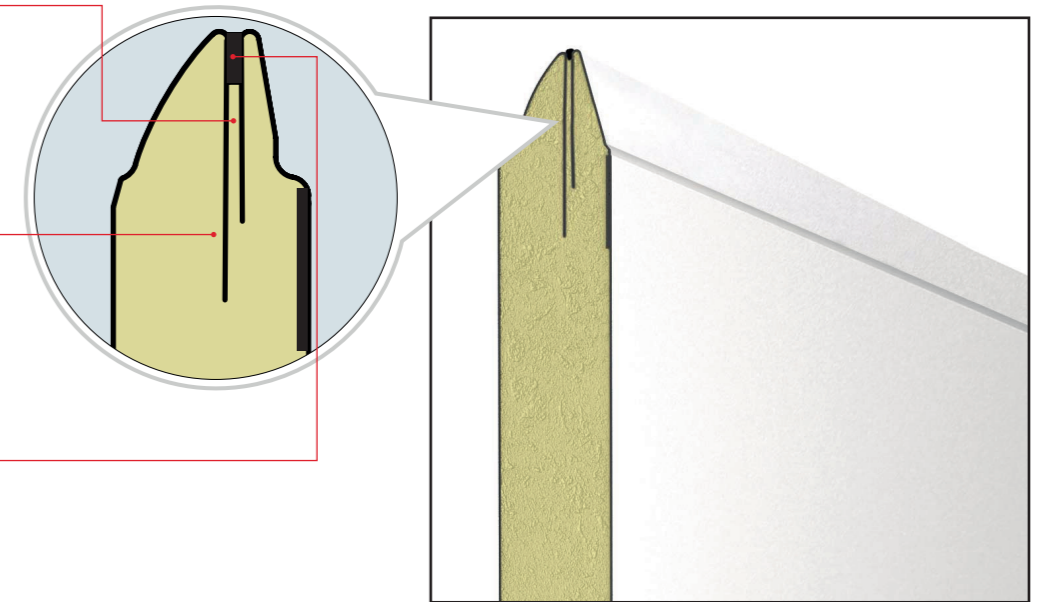

Sandwich panel is made from two sheets of galvanized steel, filled with high quality thermal insulator - foamed polyurethane, which reduces the heat loss and prolongs service life of the door. The front and back steel sheets are not connected, eliminating cold bridge effect, which ensures heat insulation and prevents from freezing. In joint is polyurethane isolated by durable and waterproof Energoflex.

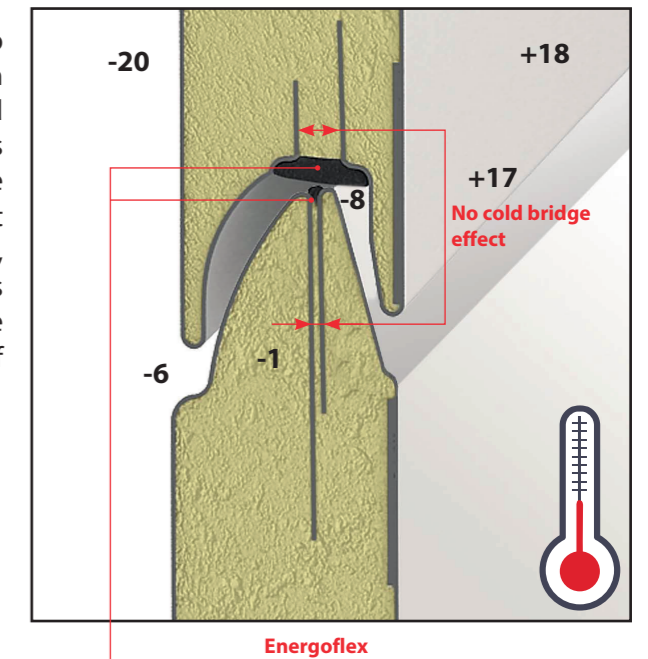

PACKAGE



For safe transportation are sandwich panels packed by 18 pieces in stacks long up to 13500 mm. The corners and the sides of the stack are covered in polystyrene and the whole package is wrapped in foil.

Every stack has its individual marking.



Kontakty

DOORHAN[®]

Královský Vrch 2018
432 01 Kadaň
Česká republika

telefon / +420 474 319 111
e-mail / kadan@doorhan.com

www.doorhan.com